

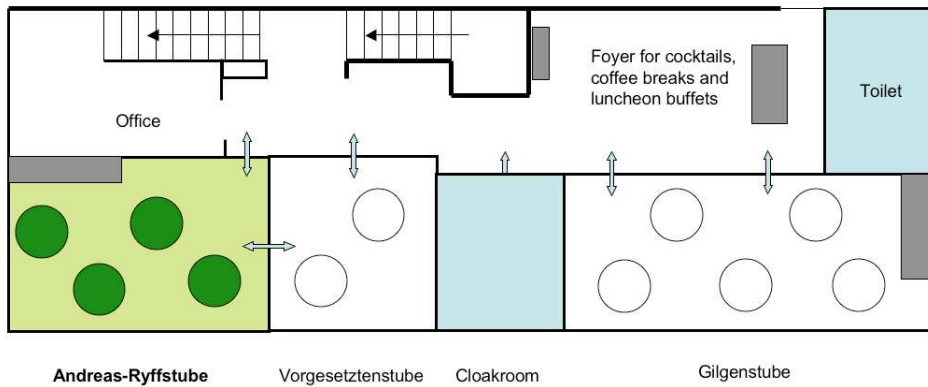

## Seatings

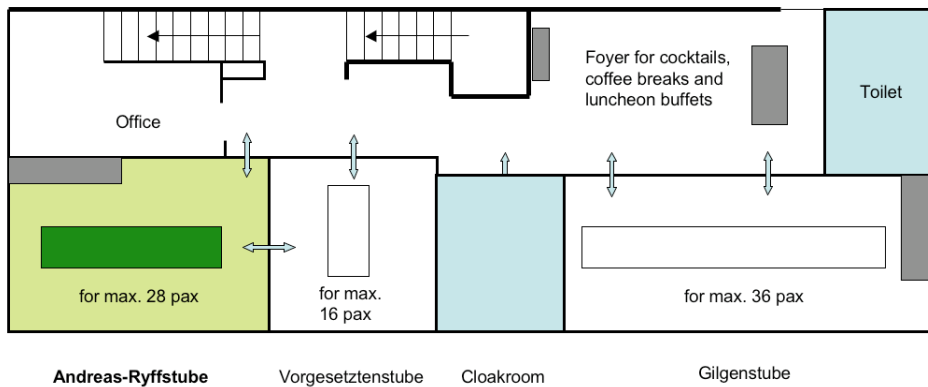

4 x 8 – 10 seats, tables Ø 180 cm, total: 40 seats



Block table, total: max. 28 seats

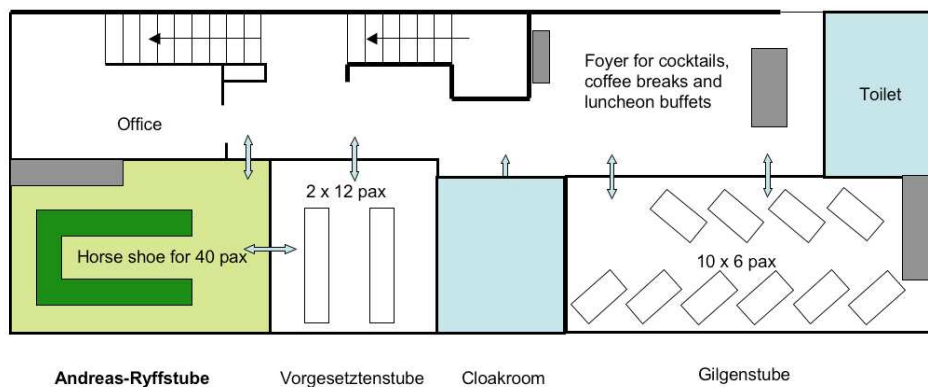

horse shoe setting, max. 40 seats

We can open the timber wall between the Vorgesetztenstube and the Andreas-Ryffstube to seat up 60 persons at round tables.

## Room rental fee and G T B – General Terms of Business

You may find our general terms of business on our homepage.